



Figure similar

Contactor AC-3 65A/30kW 400V 220 VAC, 50 Hz 3-pole, Size S2 Screw terminal

| General technical data   |                          |
|--|--------------------------|
| size of contactor  | S2                       |
| product extension auxiliary switch                             | Yes                      |
| power loss [W] for rated value of the current                  |                          |
| • at AC in hot operating state per pole                        | 7.2 W                    |
| • without load current share typical                           | 4.83 W                   |
| type of calculation of power loss current-dependent            | quadratic                |
| insulation voltage rated value                                 | 690 V                    |
| degree of pollution  | 3                        |
| surge voltage resistance rated value                           | 6 kV                     |
| protection class IP  |                          |
| • on the front   | IP20                     |
| • of the terminal  | IP00                     |
| shock resistance with sine pulse at AC                         | 15 g / 5 ms, 8 g / 10 ms |
| SVHC substance name  | Lead CAS-No. 7439-92-1   |
| Net Weight   | 0.838 kg                 |
| Ambient conditions   |                          |
| installation altitude at height above sea level maximum        | 2 000 m                  |
| ambient temperature  |                          |
| • during operation   | -10 ... +55 °C           |
| • during storage   | -25 ... +70 °C           |
| Main circuit   |                          |
| number of poles for main current circuit                       | 3                        |
| number of NO contacts for main contacts                        | 3                        |
| number of NC contacts for main contacts                        | 0                        |
| operating voltage  |                          |
| • at AC-3 rated value maximum                                  | 690 V                    |
| • at AC-3e rated value maximum                                 | 690 V                    |
| operational current  |                          |
| • at AC-1 up to 690 V at ambient temperature 40 °C rated value | 70 A                     |
| • at AC-3  |                          |
| — at 400 V rated value   | 65 A                     |
| — at 690 V rated value   | 24 A                     |
| • at AC-3e   |                          |
| — at 400 V rated value   | 65 A                     |
| — at 690 V rated value   | 24 A                     |
| operating power  |                          |

|   |  |
|---|--|
| <ul style="list-style-type: none"> <li>● at AC-3 <ul style="list-style-type: none"> <li>— at 230 V rated value</li> <li>— at 400 V rated value</li> <li>— at 690 V rated value</li> </ul> </li> <li>● at AC-3e <ul style="list-style-type: none"> <li>— at 400 V rated value</li> <li>— at 690 V rated value</li> </ul> </li> </ul> | 18.5 kW<br>30 kW<br>22 kW<br><br>30 kW<br>22 kW  |
| <b>operating frequency</b>  |  |
| <ul style="list-style-type: none"> <li>● at AC-3 maximum</li> <li>● at AC-3e maximum</li> <li>● at AC-4 maximum</li> </ul>  | 800 1/h<br>800 1/h<br>250 1/h  |
| <b>Control circuit/ Control</b>   |  |
| <b>type of voltage of the control supply voltage</b>  | AC   |
| <b>control supply voltage at AC</b>   |  |
| <ul style="list-style-type: none"> <li>● at 50 Hz rated value</li> </ul>  | 220 V  |
| <b>operating range factor control supply voltage rated value of magnet coil at AC</b>   |  |
| <ul style="list-style-type: none"> <li>● at 50 Hz</li> <li>● at 60 Hz</li> </ul>  | 0.8 ... 1.1<br>0.85 ... 1.1  |
| <b>apparent pick-up power of magnet coil at AC</b>  |  |
| <ul style="list-style-type: none"> <li>● at 50 Hz</li> <li>● at 60 Hz</li> </ul>  | 145 VA<br>155 VA   |
| <b>inductive power factor with closing power of the coil</b>  |  |
| <ul style="list-style-type: none"> <li>● at 50 Hz</li> <li>● at 60 Hz</li> </ul>  | 0.79<br>0.72   |
| <b>apparent holding power of magnet coil at AC</b>  |  |
| <ul style="list-style-type: none"> <li>● at 50 Hz</li> <li>● at 60 Hz</li> </ul>  | 12.5 VA<br>15 VA   |
| <b>inductive power factor with the holding power of the coil</b>  |  |
| <ul style="list-style-type: none"> <li>● at 50 Hz</li> <li>● at 60 Hz</li> </ul>  | 0.36<br>0.38   |
| <b>closing power of magnet coil at DC</b>   | 0.79 W   |
| <b>holding power of magnet coil at DC</b>   | 0.36 W   |
| <b>Auxiliary circuit</b>  |  |
| number of NC contacts for auxiliary contacts instantaneous contact  | 0  |
| number of NO contacts for auxiliary contacts instantaneous contact  | 0  |
| <b>operational current at AC-15</b>   |  |
| <ul style="list-style-type: none"> <li>● at 230 V rated value</li> <li>● at 400 V rated value</li> <li>● at 690 V rated value</li> </ul>  | 6 A<br>3 A<br>1 A  |
| operational current at DC-13 at 220 V rated value   | 0.3 A  |
| <b>contact reliability of auxiliary contacts</b>  | acceptability for PLC control (17 V, 5 mA)   |
| <b>Short-circuit protection</b>   |  |
| <b>design of the fuse link</b>  |  |
| <ul style="list-style-type: none"> <li>● for short-circuit protection of the main circuit <ul style="list-style-type: none"> <li>— with type of coordination 1 required</li> <li>— with type of coordination 2 required</li> </ul> </li> <li>● for short-circuit protection of the auxiliary switch required</li> </ul>             | gL/gG NH 3NA: 160 A<br>gL/gG NH 3NA: 100 A<br>fuse gL/gG: 10 A   |
| <b>Installation/ mounting/ dimensions</b>   |  |
| <b>mounting position</b>  | +/-180° rotation possible on vertical mounting surface; can be tilted forward and backward by +/- 22.5° on vertical mounting surface |
| fastening method side-by-side mounting  | Yes  |
| <b>fastening method</b>   | screw and snap-on mounting onto 35 mm DIN rail according to DIN EN 50022   |
| <b>height</b>   | 112 mm   |
| <b>width</b>  | 55 mm  |
| <b>depth</b>  | 115 mm   |
| required spacing with side-by-side mounting at the side   | 0 mm   |
| <b>Connections/ Terminals</b>   |  |

|   |   |
|---|---|
| <b>type of electrical connection</b>  |   |
| <ul style="list-style-type: none"> <li>• for main current circuit</li> <li>• for auxiliary and control circuit</li> </ul> | <p>screw-type terminals</p> <p>screw-type terminals</p>   |
| type of connectable conductor cross-sections for main contacts  |   |
| <ul style="list-style-type: none"> <li>• solid or stranded</li> <li>• finely stranded with core end processing</li> </ul> | <p>2x (0.75 ... 16 mm<sup>2</sup>)</p> <p>2x (0.75 ... 16 mm<sup>2</sup>), 1x (0.75 ... 25 mm<sup>2</sup>)</p>                                    |
| connectable conductor cross-section for main contacts finely stranded with core end processing                            | 25 mm <sup>2</sup>  |
| connectable conductor cross-section for auxiliary contacts finely stranded with core end processing                       | 0.5 ... 2.5 mm <sup>2</sup>   |
| type of connectable conductor cross-sections for auxiliary contacts   |   |
| <ul style="list-style-type: none"> <li>• solid or stranded</li> <li>• finely stranded with core end processing</li> </ul> | <p>2x (0.5 ... 1.5 mm<sup>2</sup>), 2x (0.75 ... 2.5 mm<sup>2</sup>)</p> <p>2x (0.5 ... 1.5 mm<sup>2</sup>), 2x (0.75 ... 2.5 mm<sup>2</sup>)</p> |

**Safety related data**

|  |  |
|--|--|
| product function mirror contact according to IEC 60947-4-1 | Yes  |
| <b>Electrical Safety</b>                                   |  |
| protection class IP on the front according to IEC 60529    | IP20   |
| touch protection on the front according to IEC 60529       | finger-safe, for vertical contact from the front |

**Approvals Certificates**

|   |   |            |
|---|---|------------|
| <b>Environment</b>                          | <b>General Product Approval</b>   | <b>EMV</b> |
| <a href="#">Environmental Confirmations</a> |      |            |

**other**

[Confirmation](#)



**Further information**

- Information on the packaging**  
<https://support.industry.siemens.com/cs/ww/en/view/109813875>
- Information for data generation and storage**  
<https://support.industry.siemens.com/cs/ww/en/view/109995012>
- Information- and Downloadcenter (Catalogs, Brochures,...)**  
<https://www.siemens.com/ic10>
- Industry Mall (Online ordering system)**  
<https://mall.industry.siemens.com/mall/en/en/Catalog/product?mlfb=3RT7037-1AM00>
- Service&Support (Manuals, Certificates, Characteristics, FAQs,...)**  
<https://support.industry.siemens.com/cs/ww/en/ps/3RT7037-1AM00>
- Image database (product images, 2D dimension drawings, 3D models, device circuit diagrams, EPLAN macros, ...)**  
[https://www.automation.siemens.com/bilddb/cax\\_de.aspx?mlfb=3RT7037-1AM00&lang=en](https://www.automation.siemens.com/bilddb/cax_de.aspx?mlfb=3RT7037-1AM00&lang=en)
- Cax online generator**  
<https://support.automation.siemens.com/WW/CAXorder/default.aspx?lang=en&mlfb=3RT7037-1AM00>
- Characteristic curves**  
[https://curves.simaris.siemens.com/curves/<mmp\\_prod\\_noCOMP="HAUPT"></mmp\\_prod\\_no>](https://curves.simaris.siemens.com/curves/<mmp_prod_noCOMP=)

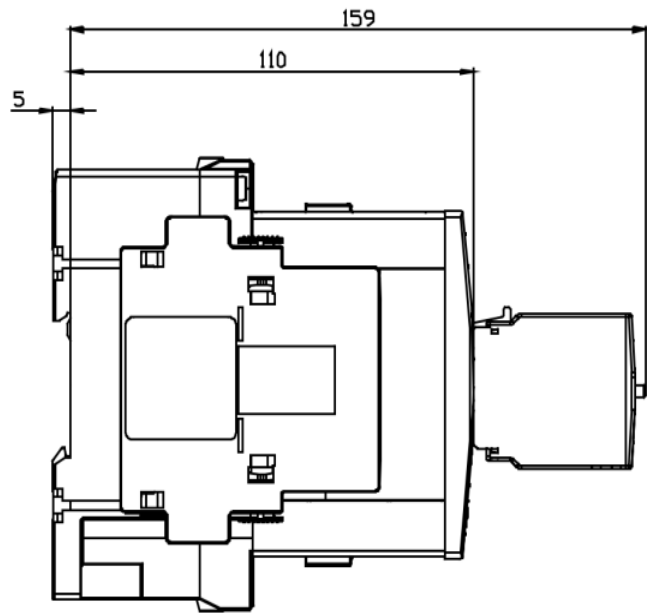
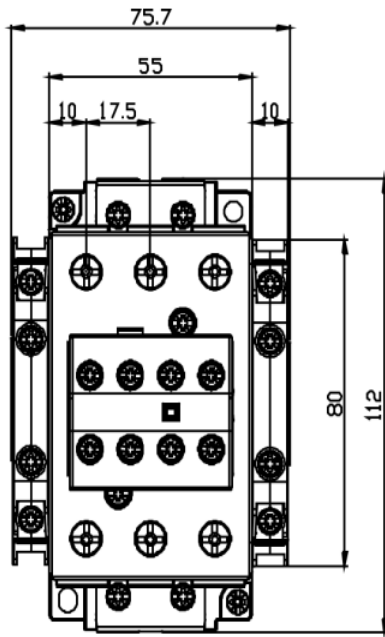

last modified:

4/4/2026 