



Miniature circuit breaker 230/400 V 6kA, 1-pole, B, 50 A Circuit breaker 230/400 V 6kA, 1-pole, B, 50 A

Figure similar

| Model | |
|--|---|
| product brand name | SENTRON |
| product designation | Miniature circuit breaker |
| General technical data | |
| number of poles | 1 |
| design of pole | 1P |
| tripping characteristic class | B |
| overvoltage category | 3 |
| degree of pollution | 2 |
| Voltage | |
| type of voltage of the operating voltage | AC |
| type of voltage | Use only in alternating current or direct current circuits. Mixed use is not permitted. |
| insulation voltage (Ui) | |
| <ul style="list-style-type: none"> with single-phase operation at AC rated value with multi-phase operation at AC rated value | 250 V 440 V |
| <ul style="list-style-type: none"> operational current <ul style="list-style-type: none"> at 30 °C rated value at 40 °C rated value at 50 °C rated value at 55 °C rated value operational current at AC rated value | 50 A 46.1 A 41.85 A 39.55 A 50 A |
| Supply voltage | |
| supply voltage at AC | 400 V |
| value range of the supply voltage frequency | 50/60 Hz |
| operating voltage | |
| <ul style="list-style-type: none"> with multi-phase operation at AC maximum at DC rated value maximum | 440 V 62.5 V The operational voltage 62,5V DC/pole takes into account a battery charging voltage with peak value of 72V |
| Protection class | |
| protection class IP | IP20, with connected conductors |
| Breaking Capacity | |
| switching capacity current | |
| <ul style="list-style-type: none"> according to EN 60898 rated value | 6 kA |
| energy limitation class | 3 |
| Dissipation | |

| | |
|---|--------------------------------------|
| power loss [W] for rated value of the current at AC in hot operating state per pole | 4 W |
| suitability for operation | Residential buildings/infrastructure |

Product details

| | |
|--|-----|
| product feature touch protection | Yes |
| product component neutral conductor switching | No |
| product feature halogen-free | Yes |
| product feature sealable | Yes |
| product feature silicon-free | Yes |
| product extension installable supplementary devices | Yes |

Connections

| | |
|---|----------------------|
| connectable conductor cross-section solid | |
| • minimum | 0.75 mm ² |
| • maximum | 25 mm ² |
| connectable conductor cross-section stranded | |
| • minimum | 0.75 mm ² |
| • maximum | 25 mm ² |
| connectable conductor cross-section finely stranded with core end processing | |
| • minimum | 0.75 mm ² |
| • maximum | 25 mm ² |
| tightening torque with screw-type terminals | |
| • minimum | 2.5 N·m |
| • maximum | 3 N·m |

Mechanical Design

| | |
|--------------------------------------|----------|
| height | 90 mm |
| width | 18 mm |
| depth | 76 mm |
| installation depth | 70 mm |
| number of modular width units | 1 |
| mounting position | any |
| Net Weight | 0.165 kg |

Environmental conditions

| | |
|--|-------------------------------------|
| vibration resistance according to IEC 60068-2-6 | 50 m/s ² at 25 to 150 Hz |
| ambient temperature during operation | |
| • minimum | -25 °C |
| • maximum | 45 °C |
| ambient temperature during storage | |
| • minimum | -40 °C |
| • maximum | 75 °C |

Approvals Certificates

| | |
|--------------------|--------------------------|
| Environment | General Product Approval |
|--------------------|--------------------------|

[Environmental Con-
firmations](#)

[Environmental Con-
firmations](#)



[Confirmation](#)

| | | |
|--------------------------|-----|-------|
| General Product Approval | EMV | other |
|--------------------------|-----|-------|



[Confirmation](#)

Further information

Information on the packaging
<https://support.industry.siemens.com/cs/ww/en/view/109813875>
 Information for data generation and storage
<https://support.industry.siemens.com/cs/ww/en/view/109995012>

Information- and Downloadcenter (Catalogs, Brochures,...)

<https://www.siemens.com/lowvoltage/catalogs>

Industry Mall (Online ordering system)

<https://mall.industry.siemens.com/mall/en/en/Catalog/product?mlfb=5SL6150-6CC>

Service&Support (Manuals, Certificates, Characteristics, FAQs,...)

<https://support.industry.siemens.com/cs/ww/en/ps/5SL6150-6CC>

Image database (product images, 2D dimension drawings, 3D models, device circuit diagrams, ...)

https://www.automation.siemens.com/bilddb/cax_en.aspx?mlfb=5SL6150-6CC

CAX-Online-Generator

<https://www.siemens.com/cax>

Tender specifications

<https://www.siemens.com/specifications>

Characteristic curves

[https://curves.simaris.siemens.com/curves/<mmp_prod_noCOMP="HAUPT"></mmp_prod_no>](https://curves.simaris.siemens.com/curves/<mmp_prod_noCOMP=)

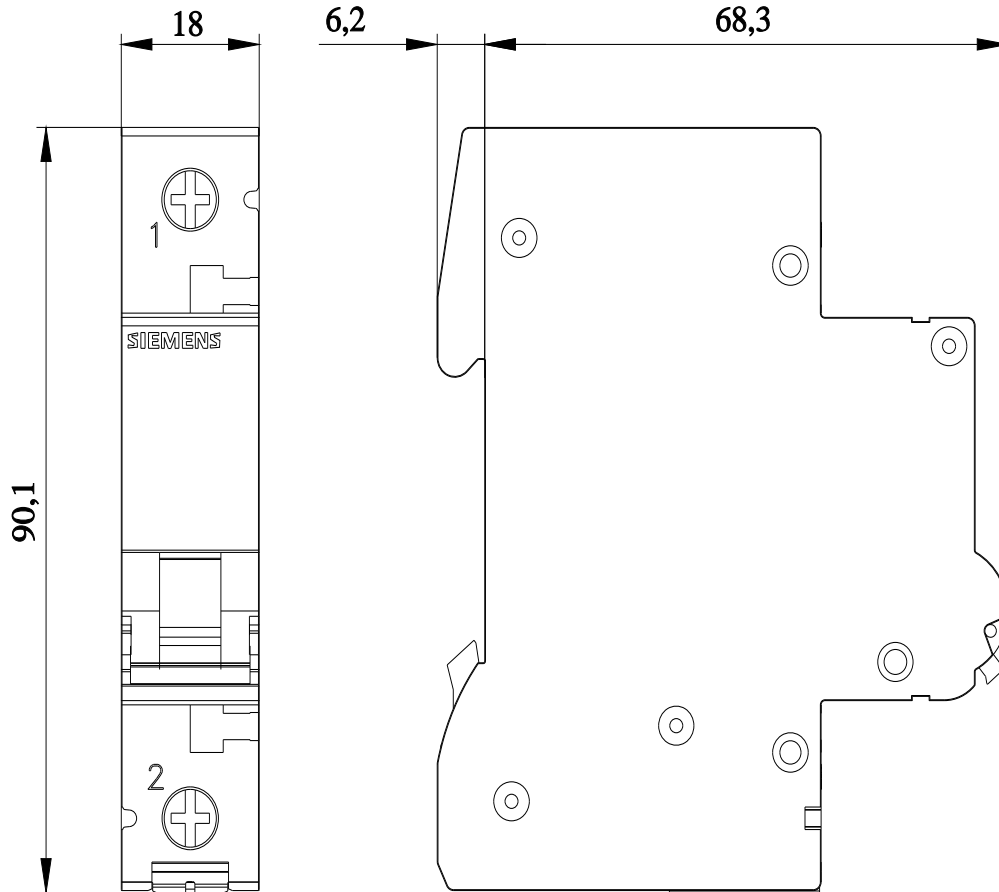



last modified:

10/10/2025 

