

Ball valve VZBC-100-FF-16-22-F0710-V4V4T

Part number: 1692209

FESTO

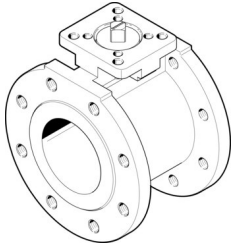

[PDF](#) General operating condition

Data sheet

Feature	Value
Structural design	2-way ball valve
Actuation type	Mechanical
Sealing principle	Soft
Mounting position	Any
Type of mounting	In-line installation
Fitting connection	Ring housing with threaded flange
Switching position indication	Slot direction = flow direction
Flange hole pattern	F07 F10
Inside diameter	96 mm
Nominal width DN	100
Valve function	2/2
Manual override	None
Flow direction	Reversible
Nominal pressure of fitting PN	16
Actuating torque	148 Nm
Based on norm	ISO 5211
Symbol	00991458
Medium	Compressed air as per ISO 8573-1:2010 [-:--] Inert gas Water – no water vapor Neutral liquids Other flow media on request
Temperature of medium	-10 °C ... 200 °C
Flow rate Kv	1414 m ³ /h
Note on materials	RoHS compliant
LABS (PWIS) conformity	VDMA24364 Zone III
Housing material	high-alloy stainless steel
Material number of housing	1,4408

Feature	Value
Seals material	PTFE PTFE-reinforced
Ball material	high-alloy stainless steel
Material number for ball	1,4408
Shaft material	high-alloy stainless steel
Material number for shaft	1,4401
Product weight	20600 g
CE marking (see declaration of conformity)	as per EU pressure equipment directive
UKCA marking (see declaration of conformity)	according to UK regulations for pressure equipment
Explosion prevention and protection	Zone 1 (ATEX) Zone 2 (ATEX) Zone 21 (ATEX) Zone 22 (ATEX)
Corrosion resistance class (CRC)	3 - High corrosion stress