



plug-in relay complete unit, 2 changeover contacts, 115 V AC, LED module red, base with logical isolation, spring-loaded terminal (push-in)

| | |
|--|-----------------------------------|
| product brand name | SIRIUS |
| product designation | Coupling relay with plug-in relay |
| product type designation | LZS |
| General technical data | |
| display version LED | Yes |
| percental drop-out voltage related to the input voltage | 15 % |
| operating frequency without load | 36 000 1/h |
| operating frequency with load | 360 1/h |
| switching behavior | monostable |
| mechanical service life (operating cycles) typical | 5 000 000 |
| electrical endurance (operating cycles) at AC-15 at 230 V typical | 80 000 |
| thermal current | 8 A |
| reference code according to IEC 81346-2 | K |
| Substance Prohibitance (day/month/year) | 05/01/2012 |
| Net Weight | 0.059 kg |
| Control circuit/ Control | |
| control supply voltage at AC | |
| • at 50 Hz rated value | 115 V |
| • at 60 Hz rated value | 115 V |
| control supply voltage frequency | |
| • 1 rated value | 50 Hz |
| • 2 rated value | 60 Hz |
| supply voltage frequency for auxiliary and control circuit rated value | 50 ... 60 Hz |
| operating range factor control supply voltage rated value at AC at 50 Hz | |
| • initial value | 0.9 |
| • full-scale value | 1.1 |
| operating range factor control supply voltage rated value at AC at 60 Hz | |
| • initial value | 0.9 |
| • full-scale value | 1.1 |
| Switching Function | |
| design of the switching function | changeover switch |
| Mechanical data | |
| product component plug-in socket | Yes |
| design of the snap-on socket base | Socket with logic isolation |
| design of the relay operating mechanism | poled |
| Short-circuit protection | |
| design of the fuse link for short-circuit protection of the auxiliary | fuse gG: 10 A |

[Environmental Confirmations](#)



[Type Test Certificates/Test Report](#)

other

[Confirmation](#)

[Confirmation](#)



Further information

Information on the packaging

<https://support.industry.siemens.com/cs/ww/en/view/109813875>

Information for data generation and storage

<https://support.industry.siemens.com/cs/ww/en/view/109995012>

Information- and Downloadcenter (Catalogs, Brochures,...)

<https://www.siemens.com/ic10>

Industry Mall (Online ordering system)

<https://mall.industry.siemens.com/mall/en/en/Catalog/product?mlfb=LZS:RT4D4S15>

Cax online generator

<https://support.automation.siemens.com/WW/CAXorder/default.aspx?lang=en&mlfb=LZS:RT4D4S15>

Service&Support (Manuals, Certificates, Characteristics, FAQs,...)

<https://support.industry.siemens.com/cs/ww/en/ps/LZS:RT4D4S15>

Image database (product images, 2D dimension drawings, 3D models, device circuit diagrams, EPLAN macros, ...)

https://www.automation.siemens.com/bilddb/cax_de.aspx?mlfb=LZS:RT4D4S15&lang=en

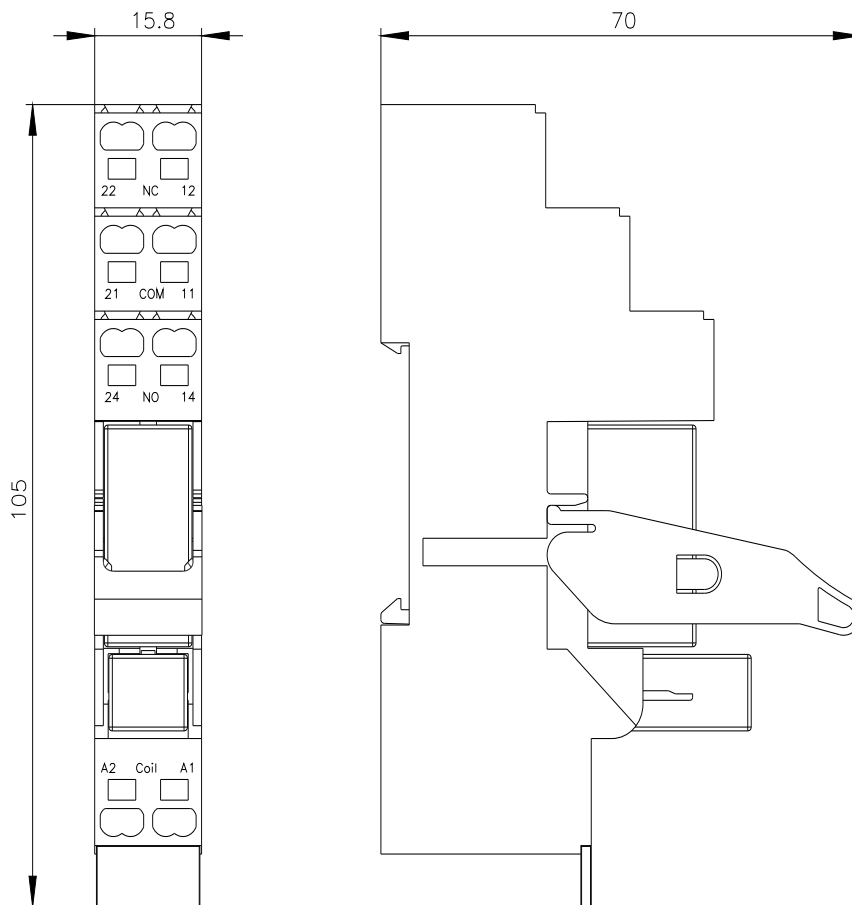

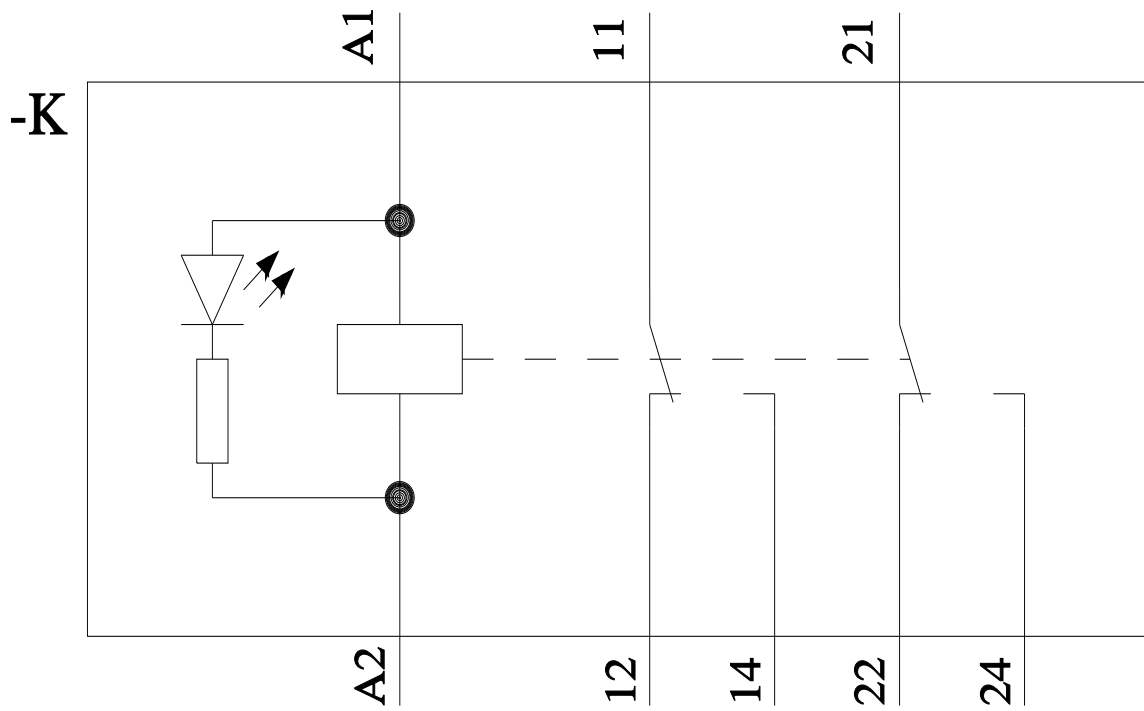

last modified:

4/2/2025 