

# Inductive proximity sensors

XS range, general purpose

Miniature, cylindrical, flush mountable

Three-wire DC, solid-state output

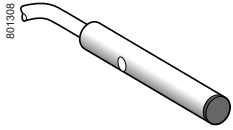

XS1L04●●310

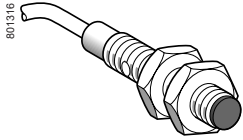

XS1N05●●310

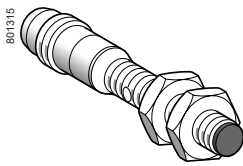

XS1N05●●311S

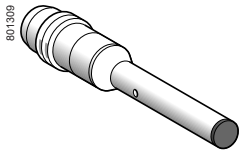

XS1L04●●310S

## Ø 4 plain (1)

Sensing distance (Sn) mm	Function	Output	Connection (2)	Reference	Weight kg
<b>Brass case, flush mountable</b>					
1	NO	PNP	Pre-cabled (L = 2 m)	<b>XS1L04PA310</b>	0,025
			M8 connector	<b>XS1L04PA310S</b>	0.010
	NPN	PNP	Pre-cabled (L = 2 m)	<b>XS1L04NA310</b>	0.025
			M8 connector	<b>XS1L04NA310S</b>	0.010
	NC	PNP	Pre-cabled (L = 2 m)	<b>XS1L04PB310</b>	0.025
			M8 connector	<b>XS1L04PB310S</b>	0.010
NPN	PNP	Pre-cabled (L = 2 m)	<b>XS1L04NB310</b>	0.025	
		M8 connector	<b>XS1L04NB310S</b>	0.010	

## Stainless steel case, flush mountable

0,8	NO	PNP	Pre-cabled (L = 2 m)	<b>XS1L04PA311</b>	0.025
			M8 connector	<b>XS1L04PA311S</b>	0.010
	NPN	PNP	Pre-cabled (L = 2 m)	<b>XS1L04NA311</b>	0.025
			M8 connector	<b>XS1L04NA311S</b>	0.010
	NC	PNP	Pre-cabled (L = 2 m)	<b>XS1L04PB311</b>	0.025
			M8 connector	<b>XS1L04PB311S</b>	0,010
NPN	PNP	Pre-cabled (L = 2 m)	<b>XS1L04NB311</b>	0.025	
		M8 connector	<b>XS1L04NB311S</b>	0.010	

## Ø 5, threaded M5 x 0.5 (1)

Sensing distance (Sn) mm	Function	Output	Connection (2)	Reference	Weight kg
<b>Brass case, flush mountable</b>					
1	NO	PNP	Pre-cabled (L = 2 m)	<b>XS1N05PA310</b>	0,030
			NPN	Pre-cabled (L = 2 m)	<b>XS1N05NA310</b>
	NC	PNP	Pre-cabled (L = 2 m)	<b>XS1N05PB310</b>	0,030
			NPN	Pre-cabled (L = 2 m)	<b>XS1N05NB310</b>

## Stainless steel case, flush mountable

0.8	NO	PNP	Pre-cabled (L = 2 m)	<b>XS1N05PA311</b>	0.030
			M8 connector	<b>XS1N05PA311S</b>	0.015
	NPN	PNP	Pre-cabled (L = 2 m)	<b>XS1N05NA311</b>	0.030
			M8 connector	<b>XS1N05NA311S</b>	0.015
	NC	PNP	Pre-cabled (L = 2 m)	<b>XS1N05PB311</b>	0.030
			M8 connector	<b>XS1N05PB311S</b>	0.015
NPN	PNP	Pre-cabled (L = 2 m)	<b>XS1N05NB311</b>	0.030	
		M8 connector	<b>XS1N05NB311S</b>	0.015	

(1) For accessories, see page 118.

(2) For a 5 m long cable add **L1** to the reference; for a 10 m long cable add **L2** to the reference.  
Example: **XS1L04PA310** becomes **XS1L04PA310L1** with a 5 m long cable.