

# Product data sheet

Specifications

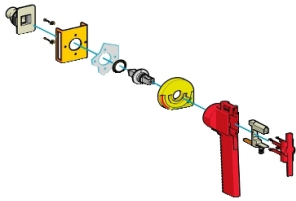

External rotary handle, TeSys GS, red handle, front mounting, 3 positions Test-I-O, IP65, for GS 630-800A IEC

GS1AHT160

! Discontinued

## Main

Range of product	TeSys
Range	TeSys
Device short name	GS1AH
Product or component type	Rotary handle
Range compatibility	TeSys TeSys GS GS1S TeSys TeSys GS GS1T
Type of operating handle	External frontal
Handle colour	Red
Handle front plate colour	Yellow

## Complementary

Handle positions	Test-O-I
Rotary handle padlocking	With
Switch rated current	630 A 800 A
Standards	IEC

## Environment

IP degree of protection	IP65
-------------------------	------

Disclaimer: This documentation is not intended as a substitute for and is not to be used for determining suitability or reliability of these products for specific user applications



## Environmental Data

Schneider Electric aims to achieve Net Zero status by 2050 through supply chain partnerships, lower impact materials, and circularity via our ongoing “Use Better, Use Longer, Use Again” campaign to extend product lifetimes and recyclability.

[Environmental Data explained >](#)

[How we assess product sustainability >](#)

### Use Longer



#### Lifetime extension

Repair

No