

# Inductive proximity sensors

XS range, Application

Selective detection of ferrous materials

Selective detection of non ferrous materials

Cylindrical type, solid-state output

Flush mountable

Stainless steel case

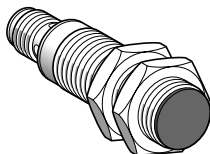

Nominal sensing distance (Sn) 5 mm

## References

3-wire, ferrous version Insensitive to non ferrous materials	PNP NO	<b>XS1M18PAS40D</b>
3-wire, non ferrous version Insensitive to ferrous materials	PNP NO	<b>XS1M18PAS20D</b>
Weight (kg)		0.060

## Characteristics

Product certifications	UL, CSA, CE
Connection	M12 connector
Degree of protection conforming to IEC 60529	IP 67
Operating zone	0...4 mm
Operating temperature	-25...+70 °C
Output state indication	Yellow LED, 4 viewing ports at 90°
Rated supply voltage	12...24 V with protection against reverse polarity
Voltage limits (including ripple)	10...38 V
Switching capacity	0...200 mA with overload and short-circuit protection
Voltage drop, closed state	≤ 2.6 V
Residual current, open state	–
Current consumption, no-load	≤ 15 mA
Maximum switching frequency	1000 Hz
Delays	
First-up	≤ 10 ms
Response	≤ 0.3 ms
Recovery	≤ 0.7 ms

## Wiring schemes

M12 connector

3-wire PNP

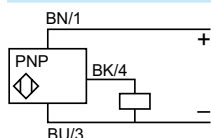

## Dimensions

XS1M

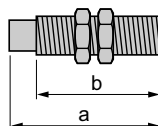

a (mm)	b (mm)
70	51.5

## Setting-up

Minimum mounting distances (mm)

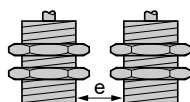

Side by side

$e \geq 10$

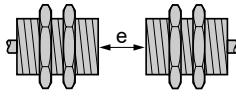

Face to face

$e \geq 60$

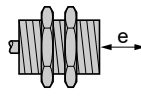

Facing a metal object

$e \geq 15$

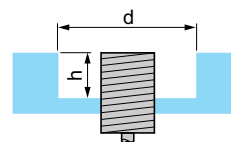

Mounted in a metal support

$d \geq 18, h \geq 0$  (ferrous metal)  
 $d \geq 18, h \geq 5$  (non ferrous metal)

XS1M18