

Product data sheet

Specifications



TeSys GV7 - circuit breaker - 3P - AC-3 - 12...20 A - thermal-magnetic

GV7RS20

⚠ Discontinued on: Oct 20, 2020

⚠ Discontinued

Main

Range	TeSys
Product name	TeSys GV7
Product or component type	Circuit breaker
Device short name	GV7R
Device application	Motor
Poles description	3P
Network type	AC
Utilisation category	AC-3 IEC 60947-4-1
Network frequency	50/60 Hz IEC 60947-4-1
Breaking capacity	50 kA Icu 500 V AC 50/60 Hz IEC 60947-2 65 kA Icu 440 V AC 50/60 Hz IEC 60947-2 100 kA Icu 220/240 V AC 50/60 Hz IEC 60947-2 70 kA Icu 380/415 V AC 50/60 Hz IEC 60947-2 10 kA Icu 660/690 V AC 50/60 Hz IEC 60947-2
[Ics] rated service short-circuit breaking capacity	100 % 440 V AC 50/60 Hz IEC 60947-2 100 % 500 V AC 50/60 Hz IEC 60947-2 100 % 220/240 V AC 50/60 Hz IEC 60947-2 100 % 380/415 V AC 50/60 Hz IEC 60947-2 100 % 660/690 V AC 50/60 Hz IEC 60947-2
thermal protection adjustment range	12...20 A
Trip unit technology	Thermal-magnetic

Complementary

Mounting mode	By screws By clips
Mounting support	Flush Panel mounting Rail Kit for fixing the switchgear
Mounting position	Vertical
Motor power kW	11 kW 500 V AC 50/60 Hz 11 kW 660/690 V AC 50/60 Hz 15 kW 660/690 V AC 50/60 Hz 9 kW 400/415 V AC 50/60 Hz 9 kW 500 V AC 50/60 Hz 7.5 kW 400/415 V AC 50/60 Hz
Control type	Rocker lever
[Ue] rated operational voltage	690 V AC 50/60 Hz IEC 60947-2
[Ui] rated insulation voltage	750 V AC 50/60 Hz IEC 60947-2

[Ith] conventional free air thermal current	20 A IEC 60947-4-1
[Uimp] rated impulse withstand voltage	8 kV IEC 60947-2
power dissipation per pole	5 W
Power dissipation per pole	5 W
Mechanical durability	50000 cycles
Electrical durability	30000 cycles AC-3 440 V In 50000 cycles AC-3 440 V In/2
maximum operating rate	25 cyc/h
Rated duty	Continuous IEC 60947-4-1
Connection pitch	1.4 in (35 mm) without spreaders 1.8 in (45 mm) with spreaders
Connections - terminals	Bars Cable with lug - external diameter: 0.4 in (10 mm) Screw Bare cable connectors 0.002...0.1 in ² (1.5...95 mm ²)
Tightening torque	88.5 lbf.in (10 N.m) screw M6 132.8 lbf.in (15 N.m) bare cable connectors 0.002...0.1 in ² (1.5...95 mm ²)
Mechanical robustness	Shocks 15 Gn for 11 ms IEC 60068-2-27 Vibrations 2.5 Gn, 0...25 Hz IEC 60068-2-6
Suitability for isolation	Yes IEC 60947-1
Phase failure sensitivity	Yes IEC 60947-4-1 § 7-2-1-5-2
Height	6.3 in (161 mm)
Width	4.1 in (105 mm)
Depth	4.4 in (111 mm)
Net weight	4.43 lb(US) (2.01 kg)

Environment

Standards	NF C 63-120 NF C 79-130 NF C 63-650 EN/IEC 60947-4-1 EN/IEC 60947-2 VDE 0660 EN/IEC 60947-1 VDE 0113
Product certifications	UL DNV
Protective treatment	TC
IP degree of protection	IP40 IEC 60529 with terminal shrouds)
Pollution degree	3
Ambient air temperature for operation	-13...158 °F (-25...70 °C)
Ambient air temperature for storage	-67...203 °F (-55...95 °C)
Fire resistance	1760 °F (960 °C) IEC 60695-2-1
Operating altitude	2000 m

Packing Units

Unit Type of Package 1	PCE
Number of Units in Package 1	1

Package 1 Height	4.3 in (11 cm)
Package 1 Width	5.9 in (15 cm)
Package 1 Length	6.7 in (17 cm)
Package 1 Weight	4.253 lb(US) (1.929 kg)

Contractual warranty

Warranty (in months)	18
-----------------------------	----



Environmental Data

Schneider Electric aims to achieve Net Zero status by 2050 through supply chain partnerships, lower impact materials, and circularity via our ongoing “Use Better, Use Longer, Use Again” campaign to extend product lifetimes and recyclability.

[Environmental Data explained >](#)

[How we assess product sustainability >](#)

Use Longer



Lifetime extension

Repair

No

Use Again



Repack and remanufacture

WEEE Label



The product must be disposed on European Union markets following specific waste collection and never end up in rubbish bins

Dimensions Drawings

GV7R

Dimensions

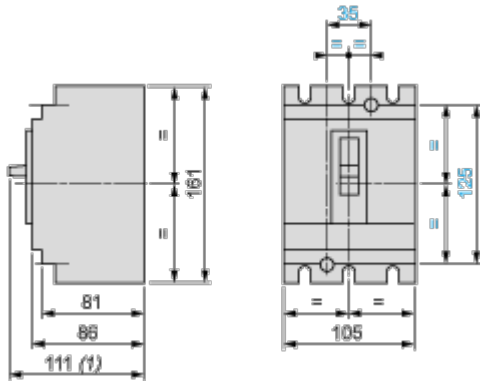

(1) 126 for GV7R_220.

Minimum Electrical Clearance

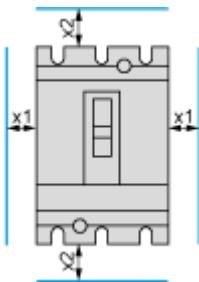

		x1	x2
Painted or insulated metal plate, insulation or insulated bar		0	30
Bare metal plate	$U \leq 440 \text{ V}$	5	35
	$440 \text{ V} < U < 600 \text{ V}$	10	35
	$U \geq 600 \text{ V}$	20	35

GV7R

Panel Mounting

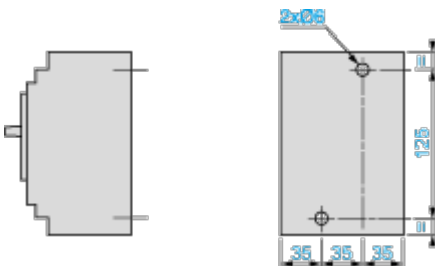

Mounting on 2 Mounting Rails DZ5 MB201

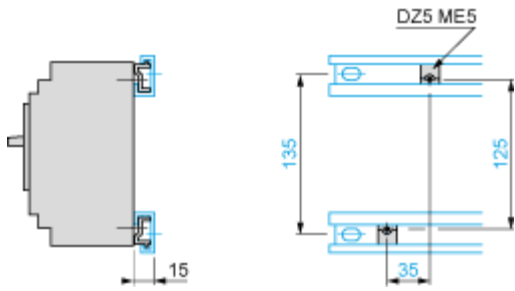

Flush-Mounting

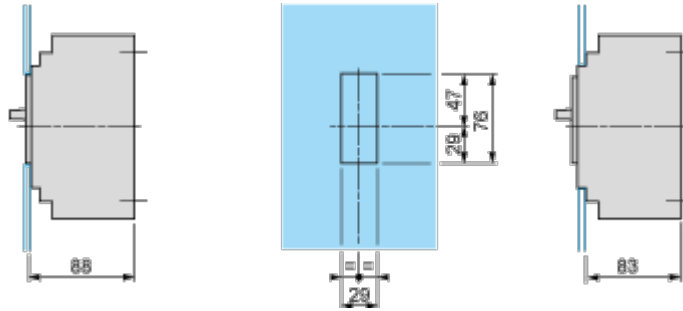

1 circuit breaker GV7R

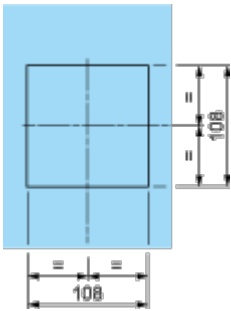

n circuit breakers GV7R side by side

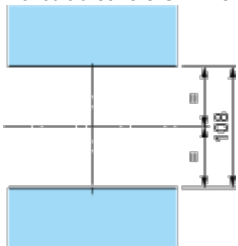

Connection

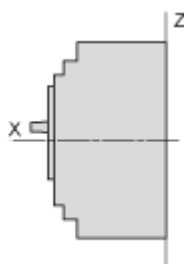

Smooth terminals

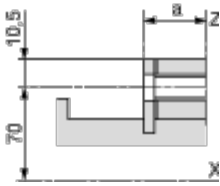

	a
GV7R _• 40...R _• 150	19.5
GV7R _• 220	21.5

Connectors

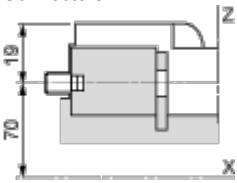

Connections and Schema

Motor Circuit Breakers

GV7 R

