

# Inductive proximity sensors

XS range, general purpose

Cylindrical, almost flush mountable, increased range

Three-wire DC, solid-state output

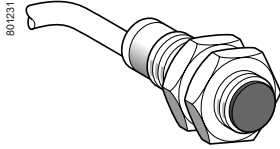

XS1N●●●●349

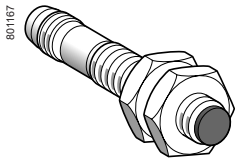

XS1N08●●●349S



XS1N●●●●349D

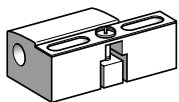

XSZB1●●

## References

Sensing distance (Sn) (mm)	Function	Output	Connection	Reference	Weight kg
<b>Ø 8, threaded M8 x 1</b>					
2.5	NO	PNP	Pre-cabled (L = 2 m)	<b>XS1N08PA349</b>	0.035
			M8 connector	<b>XS1N08PA349S</b>	0.015
			M12 connector	<b>XS1N08PA349D</b>	0.020
NC	PNP	Pre-cabled (L = 2 m)	<b>XS1N08PB349</b>	0.035	
		M8 connector	<b>XS1N08PB349S</b>	0.015	
		M12 connector	<b>XS1N08PB349D</b>	0.020	
<b>Ø 12, threaded M12 x 1</b>					
4	NO	PNP	Pre-cabled (L = 2 m)	<b>XS1N12PA349</b>	0.070
			M12 connector	<b>XS1N12PA349D</b>	0.020
			NPN	Pre-cabled (L = 2 m)	<b>XS1N12NA349</b>
	M12 connector	<b>XS1N12NA349D</b>	0.020		
	NC	PNP	Pre-cabled (L = 2 m)	<b>XS1N12PB349</b>	0.070
			M12 connector	<b>XS1N12PB349D</b>	0.020
NPN			Pre-cabled (L = 2 m)	<b>XS1N12NB349</b>	0.070
M12 connector	<b>XS1N12NB349D</b>	0.020			
<b>Ø 18, threaded M18 x 1</b>					
10	NO	PNP	Pre-cabled (L = 2 m)	<b>XS1N18PA349</b>	0.100
			M12 connector	<b>XS1N18PA349D</b>	0.040
			NPN	Pre-cabled (L = 2 m)	<b>XS1N18NA349</b>
	M12 connector	<b>XS1N18NA349D</b>	0.040		
	NC	PNP	Pre-cabled (L = 2 m)	<b>XS1N18PB349</b>	0.100
			M12 connector	<b>XS1N18PB349D</b>	0.040
NPN			Pre-cabled (L = 2 m)	<b>XS1N18NB349</b>	0.100
M12 connector	<b>XS1N18NB349D</b>	0.040			
<b>Ø 30, threaded M30 x 1.5</b>					
20	NO	PNP	Pre-cabled (L = 2 m)	<b>XS1N30PA349</b>	0.160
			M12 connector	<b>XS1N30PA349D</b>	0.100
			NPN	Pre-cabled (L = 2 m)	<b>XS1N30NA349</b>
	M12 connector	<b>XS1N30NA349D</b>	0.100		
	NC	PNP	Pre-cabled (L = 2 m)	<b>XS1N30PB349</b>	0.160
			M12 connector	<b>XS1N30PB349D</b>	0.100
NPN			Pre-cabled (L = 2 m)	<b>XS1N30NB349</b>	0.160
M12 connector	<b>XS1N30NB349D</b>	0.100			

## Accessories (1)

Description mm	Reference	Weight kg	
Fixing clamps	Ø 8	<b>XSZB108</b>	0.006
	Ø 12	<b>XSZB112</b>	0.006
	Ø 18	<b>XSZB118</b>	0.010
	Ø 30	<b>XSZB130</b>	0.020

(1) For further information, see page 118.