

# Inductive proximity sensors

XS range, Application, food and beverage processing series  
Cylindrical, stainless steel, non flush mountable  
Three-wire DC, solid-state output

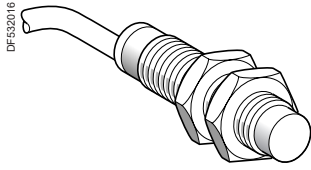

XS212SA●●L2

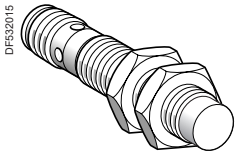

XS218SA●●M12

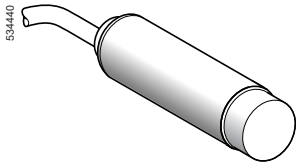

XS2L2SA●●L2

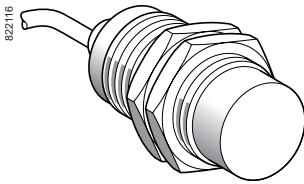

XS230SA●●L2

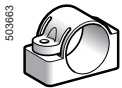

XUZB2005

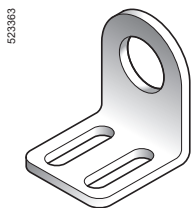

XSZBS12

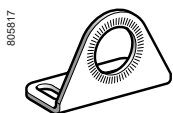

XUZA118

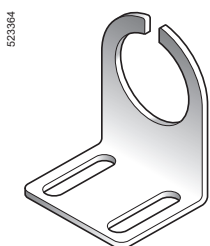

XSZBS30

### Ø 12, threaded M12 x 1

Sensing distance (Sn) mm	Function	Output	Connection	Reference	Weight kg
7	NO	PNP	Pre-cabled (L = 2 m) (1)	<b>XS212SAPAL2</b>	0.075
			M12 connector	<b>XS212SAPAM12</b>	0.035
		NPN	Pre-cabled (L = 2 m) (1)	<b>XS212SANAL2</b>	0.075
			M12 connector	<b>XS212SANAM12</b>	0.035

### Ø 18, threaded M18 x 1

Sensing distance (Sn) mm	Function	Output	Connection	Reference	Weight kg
12	NO	PNP	Pre-cabled (L = 2 m) (1)	<b>XS218SAPAL2</b>	0.120
			M12 connector	<b>XS218SAPAM12</b>	0.060
		NPN	Pre-cabled (L = 2 m) (1)	<b>XS218SANAL2</b>	0.120
			M12 connector	<b>XS218SANAM12</b>	0.060

### Ø 18, plain

Sensing distance (Sn) mm	Function	Output	Connection	Reference	Weight kg
12	NO	PNP	Pre-cabled (L = 2 m) (1)	<b>XS2L2SAPAL2</b>	0.120
			M12 connector	<b>XS2L2SAPAM12</b>	0.060
		NPN	Pre-cabled (L = 2 m) (1)	<b>XS2L2SANAL2</b>	0.120
			M12 connector	<b>XS2L2SANAM12</b>	0.060

### Ø 30, threaded M30 x 1.5

Sensing distance (Sn) mm	Function	Output	Connection	Reference	Weight kg
22	NO	PNP	Pre-cabled (L = 2 m) (1)	<b>XS230SAPAL2</b>	0.205
			M12 connector	<b>XS230SAPAM12</b>	0.145
		NPN	Pre-cabled (L = 2 m) (1)	<b>XS230SANAL2</b>	0.205
			M12 connector	<b>XS230SANAM12</b>	0.145

### Accessories (2)

Description	For use with	Reference	Weight kg
<b>Plastic fixing clamp</b> , 24.1 mm centres, with locking screw	Ø 18 sensor, plain case	<b>XUZB2005</b>	0.007
<b>Stainless steel fixing bracket</b>	Ø 12 sensor	<b>XSZBS12</b>	0.060
	Ø 18 sensor	<b>XUZA118</b>	0.045
	Ø 30 sensor	<b>XSZBS30</b>	0.080

### Connecting cables

Description	Type	Length m	Reference	Weight kg
<b>Pre-wired M12 connectors</b> Female, 4-pin, stainless steel clamping ring	Straight	2	<b>XZCPA1141L2</b>	0.090
		5	<b>XZCPA1141L5</b>	0.210
		10	<b>XZCPA1141L10</b>	0.410
	Elbowed	2	<b>XZCPA1241L2</b>	0.090
		5	<b>XZCPA1241L5</b>	0.210
		10	<b>XZCPA1241L10</b>	0.410
<b>M12 jumper cable</b> Male, 3-pin, stainless steel clamping ring	Straight	2	<b>XZCRA151140A2</b>	0.095
		5	<b>XZCRA151140A5</b>	0.200

(1) For a 5 m long cable replace L2 by L5; for a 10 m long cable replace L2 by L10.

Example: **XS212SAPAL2** becomes **XS212SAPAL5** with a 5 m long cable.

(2) For further information, see page 118.