

Product data sheet

Specifications



Discrete input module, Modicon TM5, digital 2I, 24 V DC sink, 3 wires

TM5SDI2D

⚠ Discontinued on: Dec 2, 2020

⚠ End-of-service on: Sep 1, 2024

⚠ Discontinued - Service only

Main

Range of Product	Modicon TM5
Product or Component Type	Discrete input module
Product Compatibility	Motion controller PacDrive LMC Pro PacDrive LMC Eco Logic controller PacDrive LMC Pro 2
Range Compatibility	PacDrive LMC motion controller Modicon LMC058 Modicon M258
Discrete input number	2
Discrete input logic	Sink

Complementary

Maximum supply current for sensors	500 mA
Input impedance	6.4 kOhm
Input filtering	<= 25 ms configurable by software <= 100 ms hardware
Maximum voltage drop	<2 V at 500 mA sensor supply
Net Weight	0.055 lb(US) (0.025 kg)

Environment

Marking	CE
Ambient air temperature for operation	14...131 °F (-10...55 °C) without derating horizontal installation) 14...140 °F (-10...60 °C) with derating factor horizontal installation) 14...122 °F (-10...50 °C) vertical installation)
Shock resistance	15 gn 11 ms

Ordering and shipping details

Category	22532-M258 PLC
Discount Schedule	PC12
GTIN	3595864074429
Returnability	No
Country of origin	AT

Price is "List Price" and may be subject to a trade discount – check with your local distributor or retailer for actual price.

Packing Units

Unit Type of Package 1	PCE
Nbr. of units in pkg.	1
Package 1 Height	0.8 in (2.0 cm)
Package 1 Width	2.4 in (6.0 cm)
Package 1 Length	4.3 in (11.0 cm)
Package weight(Lbs)	1.3 oz (36.0 g)

Contractual warranty

Warranty (in months)	18
----------------------	----



Environmental Data

Schneider Electric aims to achieve Net Zero status by 2050 through supply chain partnerships, lower impact materials, and circularity via our ongoing “Use Better, Use Longer, Use Again” campaign to extend product lifetimes and recyclability.

[Environmental Data explained >](#)

[How we assess product sustainability >](#)



Environmental footprint

Total lifecycle Carbon footprint	18 kg CO2 eq.
Environmental Disclosure	Product Environmental Profile
Carbon footprint of the manufacturing phase [A1 to A3]	1 kg CO2 eq.
Carbon footprint of the distribution phase [A4]	0 kg CO2 eq.
Carbon footprint of the installation phase [A5]	0 kg CO2 eq.
Carbon footprint of the use phase [B2, B3, B4, B6]	17 kg CO2 eq.
Carbon footprint of the end-of-life phase [C1 to C4]	0.1 kg CO2 eq.

Use Better



Materials and Substances

EU RoHS Directive	Pro-active compliance (Product out of EU RoHS legal scope)
REACH Regulation	REACH Declaration
California proposition 65	WARNING: This product can expose you to chemicals including: Lead and lead compounds, which is known to the State of California to cause cancer and birth defects or other reproductive harm. For more information go to www.P65Warnings.ca.gov
PVC free	Yes

Use Longer



Lifetime extension

Repair	No
--------	----

Use Again



Repack and remanufacture

Recyclability potential, in %	0
Circularity Profile	End of Life Information
WEEE Label	 The product must be disposed on European Union markets following specific waste collection and never end up in rubbish bins.

Dimensions Drawings

TM5 Slice

Dimensions

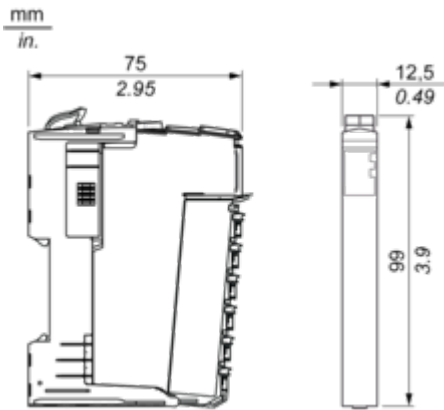

Mounting and Clearance

TM5 System

Spacing Requirements

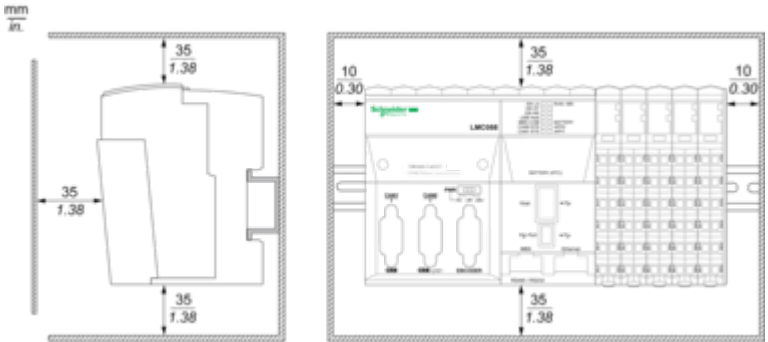



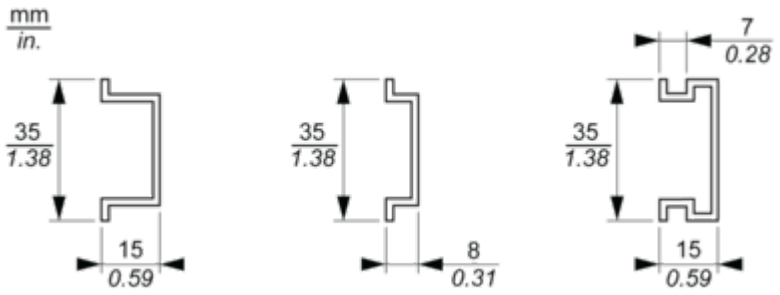

Mounting on a DIN Rail

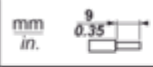

Connections and Schema

TM5 System Wiring Recommendations

Wire Sizes to Use with the Removable Spring Terminal Blocks

				
mm ²	0,08...2,5	0,25...2,5	0,25...1,5	2 x 0,25...2 x 0,75
AWG	28...14	24...14	24...16	2 x 24...2 x 18

Electronic Module 2DI 24 Vdc Sink 3 Wires

Wiring Diagram

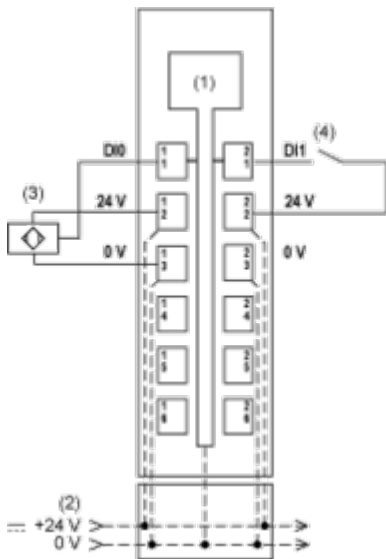

- (1) Internal electronics
- (2) 24 Vdc I/O power segment integrated into the bus bases
- (3) 3-wire sensor
- (4) 2-wire sensor