

ASIsafe extended Safety monitor 2 F-RO 2 enabling circuits IP20, with screw terminal removable terminals Safe output relay
 Response time max. 50 ms Monitor type 4, Version 3 Can be used up to Category 4 (EN954-1) up to PL E (EN ISO 13849-1) up to SIL 3 (IEC 61508)

General technical data		
design of the product		safety monitor, special version
protocol is supported AS-Interface protocol		Yes
number of release circuits		2
type of electrical connection of the inputs and outputs		screw terminal
reference code according to DIN 40719 extended according to IEC 204-2 according to IEC 750		A
reference code according to EN 61346-2		F

Ambient conditions		
ambient temperature		
<ul style="list-style-type: none"> during operation 	°C	-20 ... +60
<ul style="list-style-type: none"> during storage 	°C	-30 ... +70
protection class IP		IP20

Mechanical data		
width	mm	45
height	mm	108
depth	mm	120
fastening method		screws / DIN rail

Certificates/ approvals	
General Product Approval	EMV



EMV	Functional Safety	Maritime application	other	Environment
-----	-------------------	----------------------	-------	-------------



[Type Examination Certificate](#)



[Confirmation](#)



[Environmental Confirmations](#)

Further information

Information on the packaging

<https://support.industry.siemens.com/cs/ww/en/view/109813875>

Information for data generation and storage

<https://support.industry.siemens.com/cs/ww/en/view/109995012>

Information- and Downloadcenter (Catalogs, Brochures,...)

<https://www.siemens.com/ic10>

Industry Mall (Online ordering system)

<https://mall.industry.siemens.com/mall/en/en/Catalog/product?mlfb=3RK1105-1BE04-3CA0>

Cax online generator

<https://support.automation.siemens.com/WW/CAXorder/default.aspx?lang=en&mlfb=3RK1105-1BE04-3CA0>

Service&Support (Manuals, Certificates, Characteristics, FAQs,...)

<https://support.industry.siemens.com/cs/ww/en/ps/3RK1105-1BE04-3CA0>

Image database (product images, 2D dimension drawings, 3D models, device circuit diagrams, EPLAN macros, ...)

https://www.automation.siemens.com/bilddb/cax_de.aspx?mlfb=3RK1105-1BE04-3CA0&lang=en

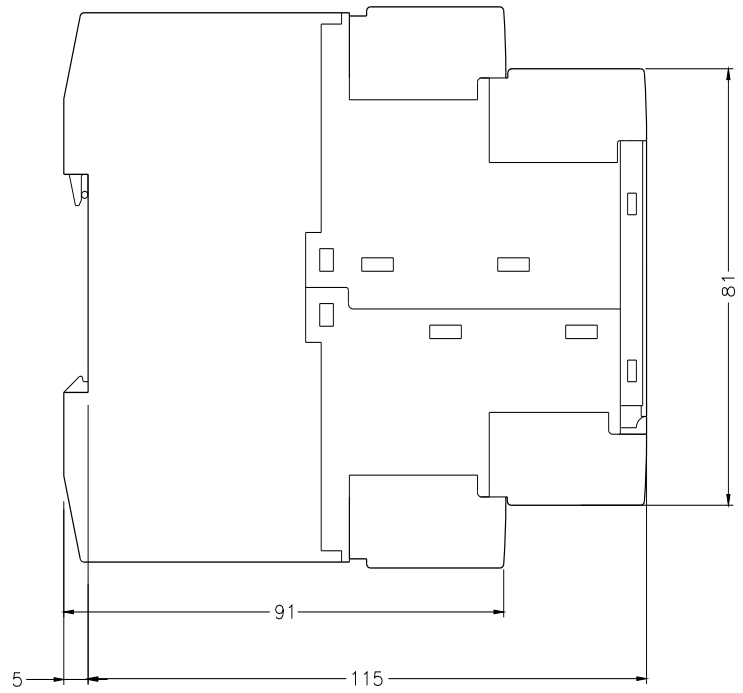
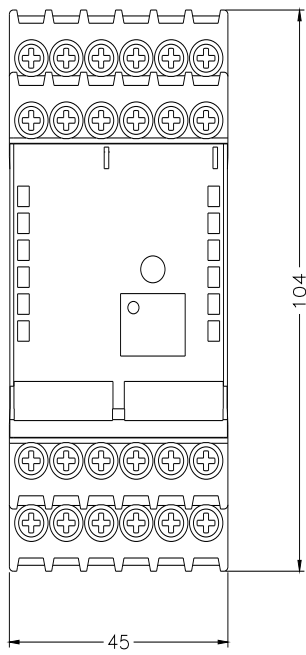

last modified:

4/1/2025 