



Figure similar

ASIsafe Basis Safety monitor 1 F-RO 1 enabling circuit IP20, with screw terminal removable terminals Safe output relay Response time max. 50 ms Monitor type 1, Version 3 Can be used up to Category 4 (EN954-1) up to PL E (EN ISO 13849-1) up to SIL 3 (IEC 61508)

General technical data		
design of the product		safety monitor, special version
protocol is supported AS-Interface protocol		Yes
number of release circuits		1
type of electrical connection of the inputs and outputs		screw terminal
reference code according to DIN 40719 extended according to IEC 204-2 according to IEC 750		A
reference code according to EN 61346-2		F
Ambient conditions		
ambient temperature		
• during operation	°C	-20 ... +60
• during storage	°C	-30 ... +70
protection class IP		IP20
Mechanical data		
width	mm	45
height	mm	108
depth	mm	120
fastening method		screws / DIN rail
Certificates/ approvals		
General Product Approval		EMV



EMV	Functional Safety	Maritime application	other	Environment
	Type Examination Certificate		Confirmation	Environmental Confirmations

Further information

Information on the packaging
<https://support.industry.siemens.com/cs/ww/en/view/109813875>
 Information for data generation and storage
<https://support.industry.siemens.com/cs/ww/en/view/109995012>
 Information- and Downloadcenter (Catalogs, Brochures,...)

<https://www.siemens.com/ic10>

Industry Mall (Online ordering system)

<https://mall.industry.siemens.com/mall/en/en/Catalog/product?mlfb=3RK1105-1AE04-1CA0>

Cax online generator

<https://support.automation.siemens.com/WW/CAXorder/default.aspx?lang=en&mlfb=3RK1105-1AE04-1CA0>

Service&Support (Manuals, Certificates, Characteristics, FAQs,...)

<https://support.industry.siemens.com/cs/ww/en/ps/3RK1105-1AE04-1CA0>

Image database (product images, 2D dimension drawings, 3D models, device circuit diagrams, EPLAN macros, ...)

https://www.automation.siemens.com/bilddb/cax_de.aspx?mlfb=3RK1105-1AE04-1CA0&lang=en

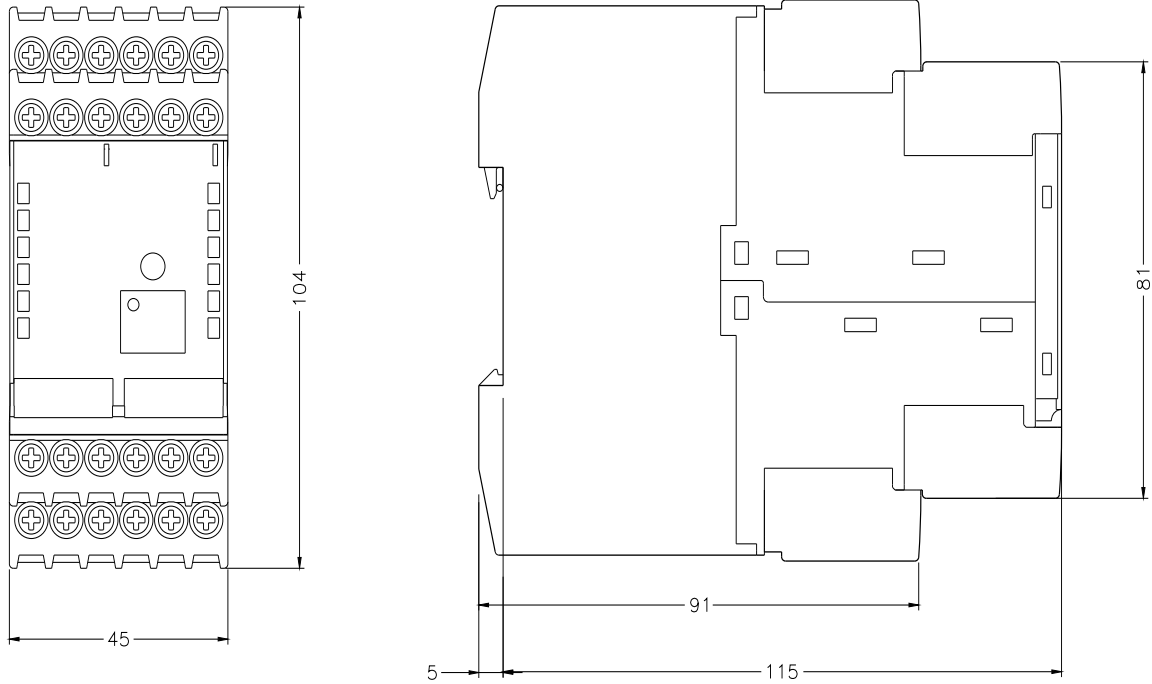

last modified:

4/1/2025 