

OsiSense XU

Photoelectric sensors—Application specific Packaging series

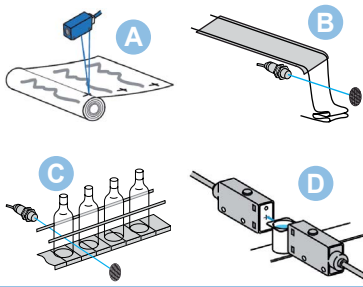

Application	A Contrast sensors		Color sensors	D Detection of aqueous liquids
System	Diffuse (with teach mode)	Diffuse (with teach mode)	Diffuse	Thru-beam infrared
Sensing distance	19 mm	9 mm (2)	0.02 m	0.2 m (1)
Mounting (mm) (MC = mounting centers)	direct: MC = 40 x 40	direct: 21 x 28, M5 screws	direct: MC = 40x40	direct: MC = 20
Sensitivity adjustment	Teach button	Teach button	Teach button	Potentiometer
Case: M (metal), P (plastic) / Setup assistance LEDs ☒	P / ☒	M / ☒	P / ☒	P / ☒
Temperature range / Degree of protection, conforming to IEC 60529	+14 to +131 °F (-10 to +55 °C) / IP65	+14 to +131 °F (-10 to +55 °C) / IP67	+14 to +131 °F (-10 to +55 °C) / IP65	+32 to +104 °F (0 to +40 °C) / IP65
Product certification	CE, cULus	CE	CE, cULus	CE
Dimensions (mm) Ø x L or H x W x D	50 x 15 x 50 (1.97 x 0.59 x 1.97)	96 x 31 x 64 (3.78 x 1.22 x 2.52)	50 x 25 x 50 (1.97 x 0.98 x 1.97)	47 x 13 x 33 (1.85 x 0.51 x 1.30)

Sensors for DC applications (solid-state output: transistor)

Connection	M12 connector	M12 connector	M12 connector – 8 pin	Precabled (2 m)
Transmitter / Receiver	3-wire PNP NO	XUKR1PSMM12	–	XUKC1PSMM12
	3-wire NPN NO	XUKR1NSMM12	–	XUKC1NSMM12
	3-wire PNP / NPN programmable NO / NC	–	XURK1KSMM12	–
Supply voltage range (V), including ripple	10–30	10–30	10–30	10.8–26.4
Switching capacity, max. (mA) / Switching frequency (Hz)	100 / 5000	200 / 10000	100 / 1500	100 / 1000



Application	B C		B C	B C
System	Diffuse (manual)	Retroreflective (potentiometer)	Retroreflective (with teach mode) (50 x 50 reflector included)	
Sensing distance	0.02–0.08 m	0.1–2 m	0–1.4 m (4)	1.5 m
Mounting (mm) (MC = mounting centers)	M18 x 1	M3 holes, MC = 24	M18 x 1	direct: MC = 40 x 40
Sensitivity adjustment	Potentiometer	Potentiometer	Teach button	
Case: M (metal), P (plastic) / Setup assistance LEDs ☒	M / ☒	P / ☒	P / ☒	
Temperature range / Degree of protection (conforming to IEC 60529)	–13 to +131 °F (–25 to +55 °C) / IP67		+32 to +131 °F (0 to +55 °C) / IP67	–13 to +131 °F (–25 to +55 °C) / IP65
Product certification	CE, CSA, UL	CE, cURus	CE, UL, CSA, C-TICK	
Dimensions, Ø x L or H x W x D, mm (in.)	Ø18 x 95 (3.74)	33 x 20 x 11 (1.30 x 0.79 x 0.43)	Ø18 x 64 (2.52)	50 x 18 x 50 (1.97 x 0.71 x 1.97)

Sensors for DC applications (solid-state output: transistor)

Connection	Precabled, PVC (2 m)				
Transmitter / Receiver	3-wire PNP programmable NO / NC	–	XUMTAPCNL2	XUBTAPSNL2 (5)	
	3-wire NPN programmable NO / NC	–	XUMTANCNL2	XUBTANSNL2 (5)	
	3-wire PNP / NPN programmable NO / NC	–	–	–	XUKT1KSML2
Connection	M12 connector		M8 connector	M12 connector	
	Transmitter / Receiver	3-wire PNP NO	XU5M18U1D	–	–
		3-wire PNP programmable NO / NC	–	XUMTAPCNM8 (3)	XUBTAPSNM12 (5)
		3-wire NPN programmable NO / NC	–	XUMTANCNM8 (3)	XUBTANSNM12 (5)
		3-wire PNP / NPN programmable NO / NC	–	–	–
Supply voltage range (V), including ripple	10–30	10–30	10–32	10–30	
Switching capacity, max. (mA) / Switching frequency (Hz)	100 / 1000	100 / 1000	100 / 1000	100 / 1500	

Accessories

Adaptable female plug-in connectors, including PUR prewired versions (6)

5 m, without LED	Wired, elbowed	Wired, straight	Screw terminal
M8 (or S) 4 pin	XZCP0666L5	XZCP0566L5	XZCC8FCM30S
M12 (or D) 4 pin	XZCP1241L5	XZCP1141L5	XZCC12FCM40B
M12 8 pin	–	XSZMCR03 (3 m)	–

Lenses for color mark

Lens for 18 mm sensing distance	Lens for 7 mm sensing distance
XURZ01	XURZ02

- (1) Nominal sensing distance 50 m. Use between 10 and 20 cm, depending on the application. (5) Also available in stainless steel for food/beverage processing applications.
 (2) 7 mm with XURZ02; 18 mm with XURZ01. To order, replace the letter A with S in the catalog number.
 (3) Also available with M12 remote connector with 0.3 m cable: replace M8 with L03M12. Example: XUBTAPSNL2 becomes XUBTSPSNL2.
 (4) 0–0.8 m for versions with 90° head. To order, replace N with W in the 8th position in the catalog number. Example: XUBTAPSNL2 becomes XUBTAPSWL2. (6) For other cable options, see page 55.