



Laser class II

Product certification CE - cULus

Forks

	Thru-beam	Thru-beam	Thru-beam laser
<b>Max. / usable sensing distance</b>	2...120 mm	2...120 mm	2...120 mm
Fixing (mm)	(see column E below)		
Sensitivity adjustment	potentiometer, 25 turn	teach button	
Case M (metal) P (plastic) / Setting-up assistance LEDs ☉	M / ☉		
Temperature range (°C) / Degree of protection (conforming to IEC 60529)	- 25...+ 60 / IP 65		
Dimensions (mm) L x H	(see columns C and D below)		

## Sensors for DC applications (solid-state output: transistor)

Connection	M8 connector (1)	M8 connector	M8 connector
<b>Type of output</b>	3-wire PNP/NPN programmable NO/NC		
Dimensions (mm) 3 choices of depth B (2)	A B C D E	A B C D E	A B C D E
<b>Transmitter / Receiver</b>	XUYF953002COS 2 40 40 60 14	XUYFANEP40002 2 42 32 57 14	XUYFALNEP40002 2 42 41 57 14
	XUYF954002COS 2 40 37 60 14	XUYFANEP40005 5 42 35 57 14	XUYFALNEP40005 5 42 44 57 14
	XUYF954015COS 15 40 50 60 27	XUYFANEP40015 15 42 45 57 27	XUYFALNEP40015 15 42 54 57 27
	XUYF954030COS 30 40 65 60 42	XUYFANEP40030 30 42 60 57 42	XUYFALNEP40030 30 42 69 57 42
	XUYF954050COS 50 57 85 77 40	XUYFANEP40050 50 42 80 57 40	XUYFALNEP40050 50 42 89 57 40
	XUYF954080COS 80 57 115 77 70	XUYFANEP40080 80 42 110 57 70	XUYFALNEP40080 80 42 119 57 70
	XUYF954120COS 120 57 155 77 110	XUYFANEP40120 120 42 150 57 110	XUYFALNEP40120 120 42 159 57 110
Supply voltage limits, min./max. (V) including ripple	10...30		10...30
Switching capacity, max. (mA) / Switching frequency (Hz)	100/500 Hz (10 kHz for XUYF953002COS)		100/10kHz
Overload and short-circuit protection (★) / LED output state indicator (☉)	★ / ☉		★ / ☉

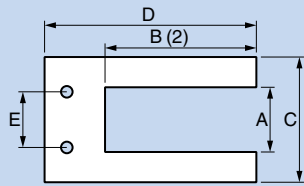

(1) For pre-cabled (L = 2 m) version, delete CO from the reference. Ex: XUYF953002COS becomes XUYF953002S.

(2) For B = 59 mm, replace the first number 4 in the reference by 6.

For B = 95 mm, replace the first number 4 in the reference by 10.

Ex: for B = 59 mm: XUYFANEP40002 becomes XUYFANEP60002.



Sensors with plastic fibre optics

	Light sensor	Colour sensor, 1 or 4 colours	Colour mark reader
<b>Max. / usable sensing distance</b>	dpg. on fibre & end fitting	2...60 mm	18 mm
Fixing (mm)	DIN rail	51 x 115	DIN rail
Sensitivity adjustment	potentiometer, numerical +/-	teach button	teach button
Case M (metal) P (plastic) / Setting-up assistance LEDs ☉	P / ☉	P / ☉	P / ☉
Temperature range (°C) / Degree of protection (conforming to IEC 60529)	0 ... + 60 / IP 65		
Dimensions (mm) L x H	13 x 60	61 x 125	60 x 30

## Sensors for DC applications (solid-state output: transistor)

Connection	M8 connector	2 x M12 connectors (included)	M8 connector
<b>Type of output</b>	PNP NO function	–	–
	NPN NO function	–	XUYDCFCO966S
	PNP/NPN Programmable NO/NC	XUYALCO966S	–
	–	XUYLC2001 (1 colour) XUYLC2004 (4 colours)	–
Supply voltage limits, min./max. (V) including ripple	10...30		10...30
Switching capacity, max. (mA) / Switching frequency (Hz)	100 / 5		100 / 20 k
Overload and short-circuit protection (★) / LED output state indicator (☉)	★ / ☉		★ / ☉
Suitable plastic fibre optics, to be ordered separately	Usable Ø 1 mm	Sensing distance	
	L = 10 m XUFZ910	18 mm L = 0.6 m XUYFPCF61	L = 0.6 m XUYFPDC61
	L = 20 m XUFZ920	60 mm L = 0.6 m XUYFPCP61	L = 1 m XUYFPDC101
	L = 50 m XUYA00550	18 mm L = 1 m XUYFPCF101	L = 0.6 m / M8 XUYFPDCM861
		60 mm L = 1 m XUYFPCP101	L = 1 m / M8 XUYFPDCM8101