

STARTER, 3RE41235AA314EY0, WITH MODS

product brand name	Siemens
product designation	Non-reversing motor starter
special product feature	Hand-Off-Auto Selector Switch
General technical data	
weight [lb]	14 lb
Height x Width x Depth [in]	14 × 8 × 7 in
touch protection against electrical shock	NA for enclosed products
installation altitude [ft] at height above sea level maximum	6 560 ft
country of origin	Germany
Power and control electronics	
number of poles for main current circuit	3
type of voltage of the control supply voltage	AC
control supply voltage	
• at AC at 50 Hz rated value	110 V
• at AC at 60 Hz rated value	120 V
disconnecter functionality	No
yielded mechanical performance [hp] for 3-phase AC motor	
• at 200/208 V rated value	10 hp
• at 220/230 V rated value	15 hp
• at 460/480 V rated value	30 hp
• at 575/600 V rated value	40 hp
Contactors	
number of NO contacts for main contacts	3
operating voltage for main current circuit at AC at 60 Hz maximum	600 V
operating voltage at AC-3 rated value maximum	600 V
mechanical service life (operating cycles) of the main contacts typical	30 000 000
Auxiliary contact	
number of NC contacts for auxiliary contacts	1
number of NO contacts for auxiliary contacts	1
number of total auxiliary contacts maximum	8
contact rating of auxiliary contacts of contactor according to UL	10A@600V(A600), 5A@600V(P600)
Coil	
apparent pick-up power of magnet coil at AC	188 VA
apparent holding power of magnet coil at AC	16.5 VA
operating range factor control supply voltage rated value of magnet coil	0.8 ... 1.1
ON-delay time	10 ... 80 ms
OFF-delay time	10 ... 18 ms
Overload relay	
product function	
• overload protection	Yes
• test function	Yes
• external reset	Yes
reset function	Manual, automatic and remote (with optional accessory)
adjustment range of thermal overload trip unit	22 ... 32
number of NC contacts of auxiliary contacts of overload relay	1
number of NO contacts of auxiliary contacts of overload relay	1
contact rating of auxiliary contacts of overload relay according to UL	5A@600VAC (B600), 1A@250VDC (R300)

Enclosure				
degree of protection NEMA rating of the enclosure	NEMA 1 standard size enclosure			
design of the housing	indoors, usable on a general basis			
Mounting/wiring				
mounting position	vertical			
fastening method	Surface mounting and installation			
type of electrical connection for supply voltage line-side	Box lug			
tightening torque [lbf-in] for supply	26 ... 39 lbf-in			
type of connectable conductor cross-sections at line-side for AWG cables single or multi-stranded	2x (18 ... 2), 1x (18 ... 1)			
temperature of the conductor for supply maximum permissible	60 °C			
material of the conductor for supply	CU			
type of electrical connection for load-side outgoing feeder	Box lug			
tightening torque [lbf-in] for load-side outgoing feeder	26 ... 39 lbf-in			
type of connectable conductor cross-sections for AWG cables for load-side outgoing feeder single or multi-stranded	2x (18 ... 2), 1x (18 ... 1)			
temperature of the conductor for load-side outgoing feeder maximum permissible	60 °C			
material of the conductor for load-side outgoing feeder	CU			
type of electrical connection of magnet coil	Screw-type terminals			
tightening torque [lbf-in] at magnet coil	7 ... 10 lbf-in			
type of connectable conductor cross-sections of magnet coil for AWG cables single or multi-stranded	2x (18 ... 2), 1x (18 ... 1)			
temperature of the conductor at magnet coil maximum permissible	75 °C			
material of the conductor at magnet coil	CU			
type of electrical connection for auxiliary contacts	Screw-type terminals			
tightening torque [lbf-in] at contactor for auxiliary contacts	7 ... 10 lbf-in			
type of connectable conductor cross-sections at contactor for AWG cables for auxiliary contacts single or multi-stranded	2x (20 ... 16), 2x (18 ... 14)			
temperature of the conductor at contactor for auxiliary contacts maximum permissible	75 °C			
material of the conductor at contactor for auxiliary contacts	CU			
type of electrical connection at overload relay for auxiliary contacts	Screw-type terminals			
tightening torque [lbf-in] at overload relay for auxiliary contacts	7 ... 10 lbf-in			
type of connectable conductor cross-sections at overload relay for AWG cables for auxiliary contacts single or multi-stranded	2x (20 ... 16), 2x (18 ... 14)			
temperature of the conductor at overload relay for auxiliary contacts maximum permissible	70 °C			
material of the conductor at overload relay for auxiliary contacts	CU			
Short-circuit current rating				
design of the fuse link for short-circuit protection of the main circuit required	Class J			
design of the short-circuit trip	Thermal magnetic circuit breaker			
maximum short-circuit current breaking capacity (I _{cu})				
• at 240 V	5 kA			
• at 480 V	5 kA			
• at 600 V	5 kA			
certificate of suitability	UL 60947-4-1			
Approvals Certificates				
General Product Approval	Test Certificates	other	Dangerous goods	Environment



[Confirmation](#)



[Transport Information](#)

[Environmental Confirmations](#)

Further information

Industrial Controls - Product Overview (Catalogs, Brochures,...)

www.usa.siemens.com/iccatalog

Industry Mall (Online ordering system)

<https://mall.industry.siemens.com/mall/en/us/Catalog/product?mlfb=3RE4123-5AA31-4EF6>

Search Datasheet in Service&Support (Manuals)

<https://support.industry.siemens.com/cs/US/en/ps/3RE4123-5AA31-4EF6/man>

Image database (product images, 2D dimension drawings, 3D models, device circuit diagrams, EPLAN macros, ...)

https://www.automation.siemens.com/bilddb/cax_de.aspx?mlfb=3RE4123-5AA31-4EF6&lang=en

Certificates/approvals

<https://support.industry.siemens.com/cs/US/en/ps/3RE4123-5AA31-4EF6/certificate>

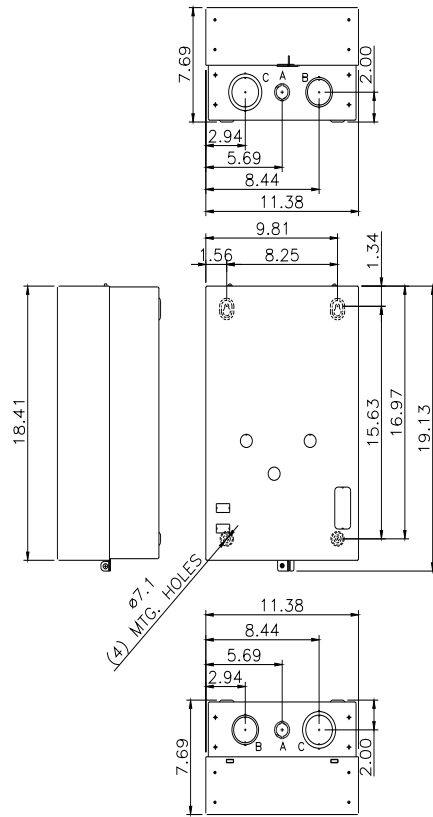

LETTER	KNOCKOUT & CONDUIT SIZE
A	ø22.2 X ø28.6 FOR 12.7 & 19 CONDUIT
B	ø43.8 X ø50 FOR 31.8 & 38.1 CONDUIT
C	ø50 X ø62.7 FOR 38.1 & 50.8 CONDUIT

last modified:

10/22/2025