

Product datasheet

Specifications

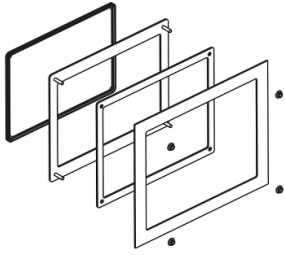

Panel cutout adapter, Harmony P6/
FP6, to mount 15-inch wide display
Module in cutout for Harmony IPC
Modular/S-Panel PC (15" wide)

HMIZPAT7W1

Main

Range of product	Harmony P6 Harmony FP6
Product or component type	Panel adaptor
Accessory / separate part category	Adaptation accessory Adaptation accessory
Range compatibility	Harmony P6 Harmony FP6

Complementary

Accessory / separate part destination	15" wide Harmony P6 display 15" wide Harmony FP6
---------------------------------------	---

Packing Units

Unit Type of Package 1	PCE
Number of Units in Package 1	1
Package 1 Height	3.700 cm
Package 1 Width	43.700 cm
Package 1 Length	29.900 cm
Package 1 Weight	1.010 kg
Unit Type of Package 2	S35
Number of Units in Package 2	4
Package 2 Height	15.000 cm
Package 2 Width	40.000 cm
Package 2 Length	60.000 cm
Package 2 Weight	4.912 kg

Contractual warranty

Warranty (in months)	18
----------------------	----

Disclaimer: This documentation is not intended as a substitute for and is not to be used for determining suitability or reliability of these products for specific user applications



Environmental Data

Schneider Electric aims to achieve Net Zero status by 2050 through supply chain partnerships, lower impact materials, and circularity via our ongoing “Use Better, Use Longer, Use Again” campaign to extend product lifetimes and recyclability.

[Environmental Data explained >](#)

[How we assess product sustainability >](#)

Use Better



Materials and Substances

Packaging made with recycled cardboard	Yes
Packaging without single use plastic	No
EU RoHS Directive	Compliant
REACH Regulation	Free of Substances of Very High Concern above the threshold
Halogen-free status	Product contains halogen above thresholds
PVC free	No
Silicone-free	No

Use Longer



Lifetime extension

Repair	No
--------	----

Use Again



Repack and remanufacture

End of life manual availability	No need of specific recycling operations
Take-back	No